

DATA SHEET

PRODUCT DESCRIPTION

The CAR2P-ECOGRAPH trolley stands out for its design and quality, offering maximum comfort and reliability. Designed to meet all needs, it is a device conceived for the support and movement of medical and electromedical equipment. Its versatility makes it ideal, guaranteeing an excellent quality-price ratio. The load-bearing structure is made of sturdy steel, treated with epoxy powder coating by means of a 200° thermal tunnel.

TECHNICAL FEATURES

ELEMENT(S).	DESCRIZIONE
SHELF(S).	Made of steel sheet with a thickness of 20/10 mm and dimensions of 400x360 mm. Treated with an epoxy paint finish, complete with accessories included.
COLUMN(S).	The load-bearing structure is composed of a 95 cm extruded aluminium side member, exclusively patented, with the upper part of the upright closed by a thermoplastic cap.
BASE	Base In tubular steel measuring 60/30 x 2, with sheet metal that acts as a shelf Useful area 590x590 mm
BASKET	No.1 Height-adjustable basket made of plastic material
WHEELS	Diameter: Ø80 mm Equipped with two front brakes to ensure stability and safety during use, while facilitating convenient movement of the unit.
OPTIONAL	Cable support arm, Large probe holder, Additional shelf, Pneumatic lifting column Column with gasket for cable passage Colors: Dark gray, White, Blue
PAINTING	The structure is completely painted with epoxy powders, treated via a thermal tunnel at 200°.



TECHNICAL FEATURES

Description

Load-bearing structure composed of n.1 H.95 cm side member in extruded aluminium produced and patented by us exclusively. The upper part of the upright is closed with a special cap in thermoplastic material

Base In tubular steel measuring 60/30 x 2 with sheet metal acting as a shelf

- No. 1 Shelf in painted steel sheet adjustable in height, suitable for supporting electromedical machines measuring 45x43 cm equipped with front handle, probe holder, and printer holder
- Four twin wheels Ø 80 mm, the front ones are complete with double action brake
- No. 1 Height-adjustable basket made of plastic material
- Structure entirely painted with epoxy powders in a thermal tunnel at 200°

Base

-The structure, with 60/30 steel tubular crosspieces, is solid and designed to prevent any overturning.

-The side crosspiece, onto which the aluminium support bar is screwed using screws, houses the four wheels in the lower part.

-Plastic caps are placed at the ends of the bars to act as bumpers.

-Treatment with epoxy paint finish in thermal tunnel

Wheels

Support	Polyamide
Pirouetting	on a double row of spheres
Band	in black antistatic/conductive and non-marking rubber
Core	Polyamide
Diameter	80 mm
Flow rate	50 kg each, in case of dynamic load.
Front wheels	with double action brake (simultaneous blocking of swiveling and rolling)
Fixing	fixing to the base with a snap-on system

TECHNICAL FEATURES

Uprights

-Nr. 1 central upright firmly fixed to the base of the trolley by means of two M10x50 screws in galvanized steel. The upright is equipped with 2 tracks (slots) arranged longitudinally, which allow the various components of the trolley and any accessories to be fixed. All the elements fixed to the uprights are adjustable in height.

-Treatment with epoxy paint finish.

Accessories included

Basket: Made of plastic material with special holes for air passage, the basket is adjustable in height according to needs.

- Printer holder housing internal dimensions D.30cm - H.12cm - L.17.5cm
- Front handle that allows easy movement
- 4-position probe holder accessory

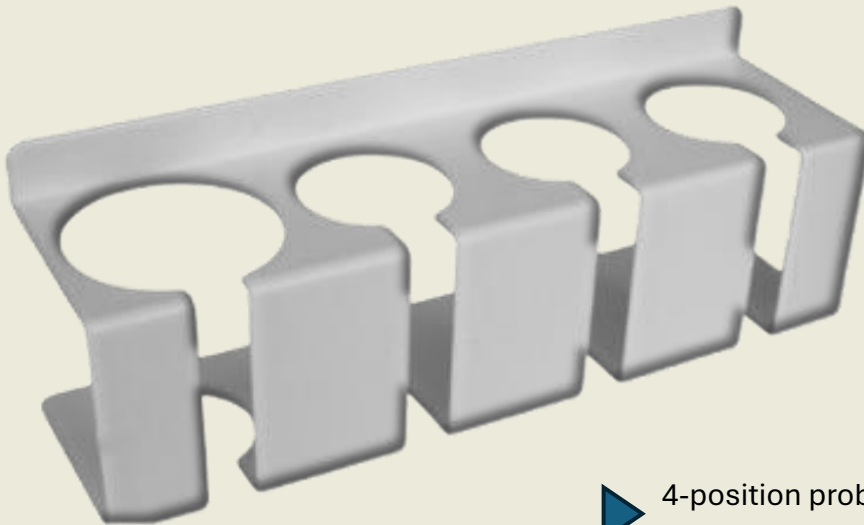

▶ 4-position probe holder accessory

TECHNICAL FEATURES

Compliant with Regulation (EU) 2017/745 on Class I Medical Devices

CUSTOM SOLUTIONS



Scan To Visit Our Website

To visit our websites, open your phone's camera app and scan the QR code below,

www.kartmedsolutions.com

